

FEATURES / SPECIFICATIONS

- Shower tray drain made of PP.
- Drainage capacity (height of 15mm): 0.61 l/s
- DN (nominal diameter): Ø 40 mm
- Diameter shower tray drain hole: 90 mm
- Water seal level 50mm
- Robust fixing system by stainless steel flange and three screws.
- Easy access system for pipe cleaning.
- Thermally resistant: max 95°C.
- Bilabial seal.
- Possibility of removing the siphon, if it already exists in the installation.
- Hair catchers filter included.
- Installation manual included.



MODELS / REFERENCES

Reference	Dimensions	Description
A27L018000	150x200x78	SHOWER TRAY DRAIN Ø 90

STANDARDS

Meets the following standard:

- EN-274-1

INSTALLATION NOTES

- Install this product according to installation manual provided.

CHARACTERISTICS

- Removable hair catchers filter. ①
- Removable siphon valve, for cleaning the drain or if shower tray drain is connected to a central siphon trap. ②

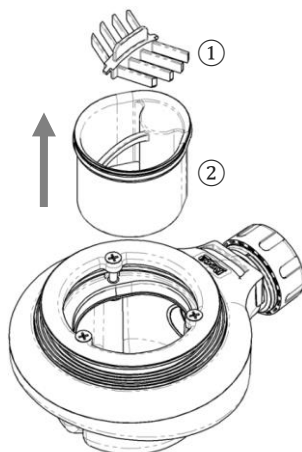

- Drain pipe systems can be inspected and cleaned with a plumber's snake through the maintenance register, previously removing the registration plug.③

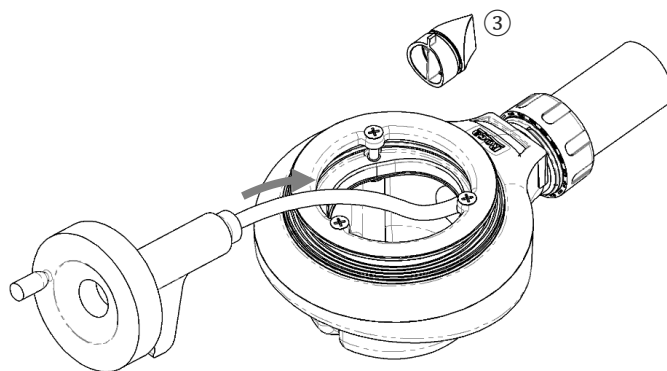

PRODUCT DIAGRAM

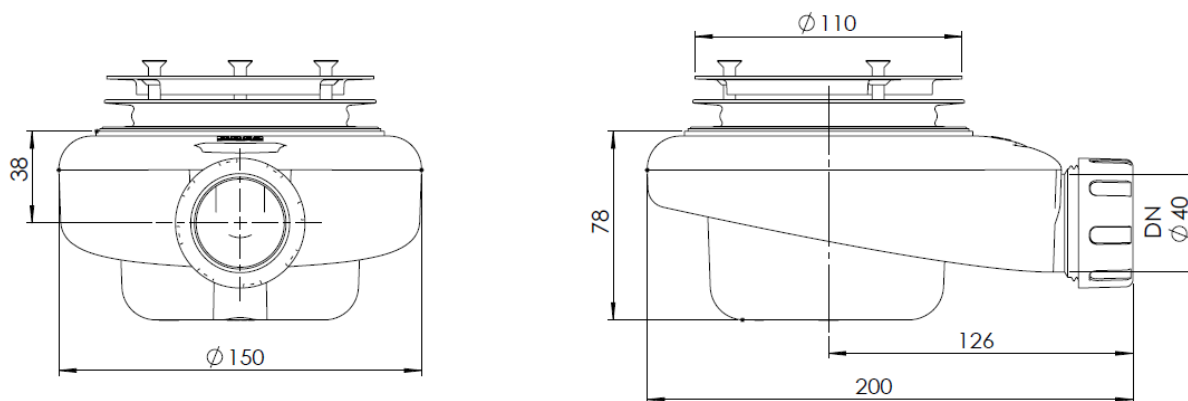

All dimensions are nominal, in millimetres, are subject to normal manufacturing variations.
Dimensions and specifications are subject to change without prior notice

ATEC-00027L018 - January 2020
Supersedes all previous issues



Roca Sanitario, S.A. Avda. Diagonal, 513
08029 Barcelona Spain
website : www.roca.com
e-mail : productsupport.rs@roca.net